

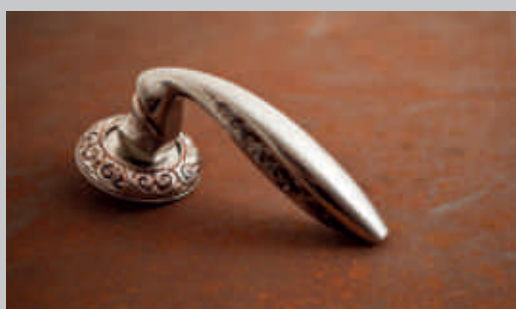



PORCELLANA

PAGINA/PAGE 18



TIMELESS

PAGINA/PAGE 38



PELLE

PAGINA/PAGE 90



SWAROVSKI

PAGINA/PAGE 97

PAGINA  
PAGE

20-21



TASHA 1028P

22-23



ANASTASIA 198

24-25



LADY 148

26-27



FLORA 147P

28-29



MICHELLE 106P

30-31



DOLL 142

32-33



MARINA 108

34-35



STONE 161S

36-37



SQUARE P 160P

40-41



NICOLE 1377

42-43



BLOSSOM 1378

44-45



RETRÒ 1380

46-47



DUFFY 1379

48-49



TASHA 1028





PAGINA PAGE			PAGINA PAGE		
50-51		MICHELLE 106	78-79		WILD 157
52-53		ANNA 177	80-81		EAGLE 150
54-55		ANNA ESSENCE 117.2	82-83		DAMA 156
56-57		FLORA 147	84-85		DUCK 153
58-59		REGINA 105	86-87		STEFANIA 195
60-61		VITTORIA 173	88-89		ALT WIEN 196
62-63		NINA 172	92		BAU 137L
64-65		WIEN 109	92		BAU 137L
66-67		JULIETTE 152	93		1028L
68-69		PARIS 154	93		106L
70-71		CALLIOPE 151	94		160.3
72-73		PISA 119	95		193
74-75		ROMA 178	95		112
76-77		RODI 138	98-99		SWAROVSKI



VAL SABBIA



## LA STORIA

Il patron della nostra azienda, Vittore Bianchi vanta una ricca e lunga esperienza nel settore artigianale. I suoi esordi lavorativi lo hanno visto impegnato nel campo dell'automotive, dove ha affinato le sue naturali doti di curiosità e dedizione per il proprio lavoro e per il prodotto che era intento, di volta in volta, a realizzare. Chiusa questa prima esperienza, si è avvicinato, in qualità di agente di vendita di un prodotto ausiliario (le vernici) al mondo delle maniglie e delle realtà che le producevano. In quella fase, sul finire degli anni Settanta, la terra d'origine di Vittore era già conosciuta come uno dei più importanti distretti industriali delle maniglie. Centinaia di operatori della vallata, con migliaia di collaboratori, erano impegnati in questo settore, espressione del Made in Italy. L'innata curiosità di Vittore ha portato a fondare una azienda che effettuava lavorazioni per conto terzi, nell'ambito dell'articolata filiera produttiva delle maniglie. Questa prima espe-

rienza imprenditoriale era nata durante uno dei periodi più dinamici del distretto delle maniglie valsabbino: non mancavano certo le occasioni per ampliare il proprio business a chi, come Vittore, era dotato di spirito d'intraprendenza. Non è un caso infatti che in nostro fondatore abbia partecipato a fiere e rassegne internazionali del settore, con l'obiettivo di comprendere le esigenze e le specifiche richieste degli operatori internazionali, che erano a contatto con i clienti – aziende e privati – fruitori finali delle maniglie. Forte di questa esperienza, Vittore fonda nel 1986 la Fimet, acronimo di Finitura Metalli. In quell'anno il mercato di riferimento delle produzioni della nuova azienda era quello tedesco ma ora, a distanza di quasi un trentennio dagli esordi, i mercati raggiunti e serviti dalle produzioni dell'azienda della famiglia Bianchi sono oltre venti. I figli di Vittore sono impegnati attivamente nella ditta, Luca è responsabile della qualità e della produzione, mentre Marica è responsabile delle vendite. Il carattere familiare dell'azienda è infatti il suo punto di forza "non ci limitiamo a produrre maniglie, ma ne curiamo ogni aspetto, dalla ideazione fino alla finitura, siamo orgogliosi di rappresentare il made in Italy".







## HISTORY

The owner of our company, Vittore Bianchi has a rich and long experience in the craft field. First he has been engaged in the automotive field, where he honed his natural curiosity and dedication to its own work and for the product that he was concentrated, from time to time, to realize. Closed this first experience, he approached, as a sales agent of an auxiliary product (paint), the world of handles and the realities that produced them. At that stage, in the late seventies, the birthplace of Vittore was already known as one of the most important industrial areas of the handles production. Hundreds of entrepreneurs in the valley, with thousands of employees, were engaged in this sector, expression of Made in Italy. The innate Vittore's curiosity, combined with his entrepreneurial spirit, led him to found a company which carried out work for third parties, as part of the articulated

chain of the handles production. This first experience was born during one of the most dynamic districts handle Valsabbia: there were some opportunities to expand the business to those who, like Vittore, was endowed with the spirit of enterprise. It is no coincidence that our founder has participated in international exhibitions and fairs of the sector, with the aim to understand the needs and the specific requirements of international operators, who were in contact with the final customers. Based on this experience, Victor founded in 1986 Fimet, acronym of metal finishing. In that year the reference market of the new company was the German one but now, after almost thirty years from the beginning, the markets reached and served by the company of the Bianchi family are over twenty. The children of Vittore are actively involved in the company, Luca is responsible for quality and production, while Marica is responsible for sales. The family nature of the company is its strong point "we do not just produce handles, but we take care of everything from conception to finish, we are proud to represent the Made in Italy".



## IL NOSTRO OBIETTIVO





La scelta di materiali sempre di prima qualità, e l'attenzione per l'ambiente sono i tratti distintivi che guidano l'operato di Fimet. In questa scia s'inseriscono a pieno titolo l'attenzione con la quale la nostra azienda studia prima e progetta poi i modelli di maniglie. Oggetti adatti a soddisfare le specifiche esigenze della vasta clientela. Come da tradizione, accurata ricerca di soluzioni tanto tecniche quanto stilistiche volte a venire incontro alle richieste dei nostri clienti sono, esse stesse, la migliore garanzia di una produzione di alta gamma. Non occorre certo sottolineare che la flessibilità e la professionalità insite nella realizzazione della nostra produzione contraddistinguono la nostra attività. Da sempre Fimet offre un'attenzione particolare alle specifiche esigenze della propria clientela: soluzioni tecniche personalizzate, servizi di vendita e post-vendita mirati fanno parte della nostra cultura aziendale. Fimet è un'azienda che rappresenta nel mondo l'eccellenza produttiva del Made in Italy: la cura per i dettagli, la scelta delle materie prime, la passione che guida i nostri responsabili sono sinonimo di qualità.





OUR TARGET

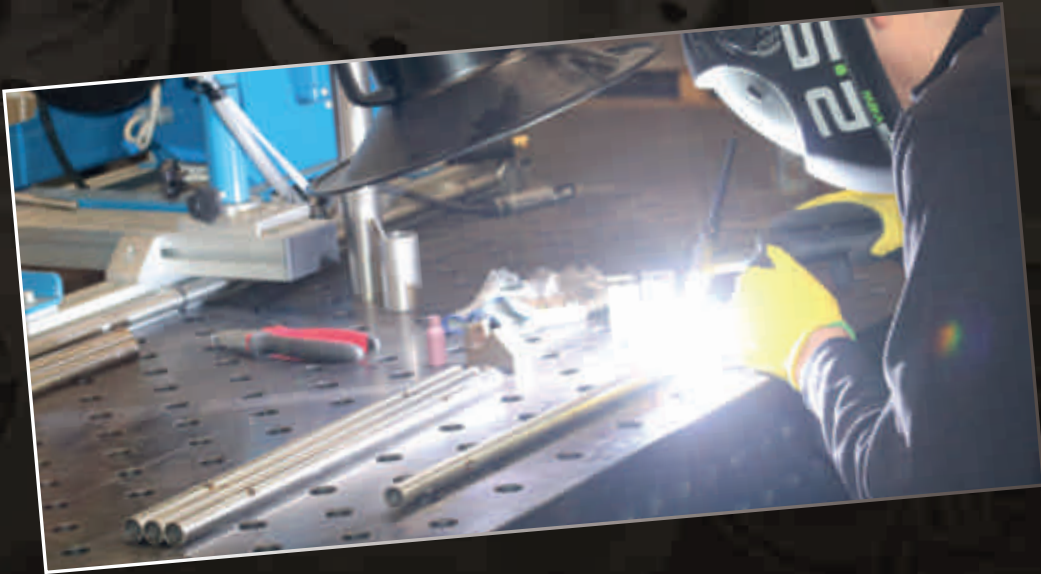



The choice of top quality materials and attention to the environment are the hallmarks that guide the work of Fimet. In this path they are fully inserted the care with which our company studies first and then designs the new models of handles. Objects suitable to satisfy the specific needs of its clientele. As per tradition, the careful search for stylistics as well as technical solutions designed to meet the demands of our customers are, themselves, the best guarantee of a high-end production. It is certainly not necessary to emphasize that the flexibility and professionalism inherent in the realization of our production characterize our activity. Fimet always pays special attention to the specific needs of its customers: customized technical solutions, aimed sales and post-sales services are part of our corporate culture. Fimet is a company that represents in the world the manufacturing excellence of Made in Italy: the attention to detail, the choice of the materials, the passion that drives our managers are synonymous of quality.



# DESIGNERS

BIANCHI



GALLO



NOVAGUE



GANDI



FOLLESA



BELLEZZA  
A PORTATA DI MANO



Come da migliore tradizione italiana, per la creazione e prototipazione delle ns maniglie ci avvaliamo di artigiani e designer.

La ns collaborazione consiste nello sviluppare insieme a loro nuove idee di maniglie, fare i prototipi e studiare le modifiche necessarie a renderle adatte alla commercializzazione.

*As in the best Italian tradition, for the creation and prototyping of our handles we employ craftsmen and designers.*

*Our collaboration is to develop with them new ideas for handles, make prototypes and study the changes needed to make them ready for commercialization.*

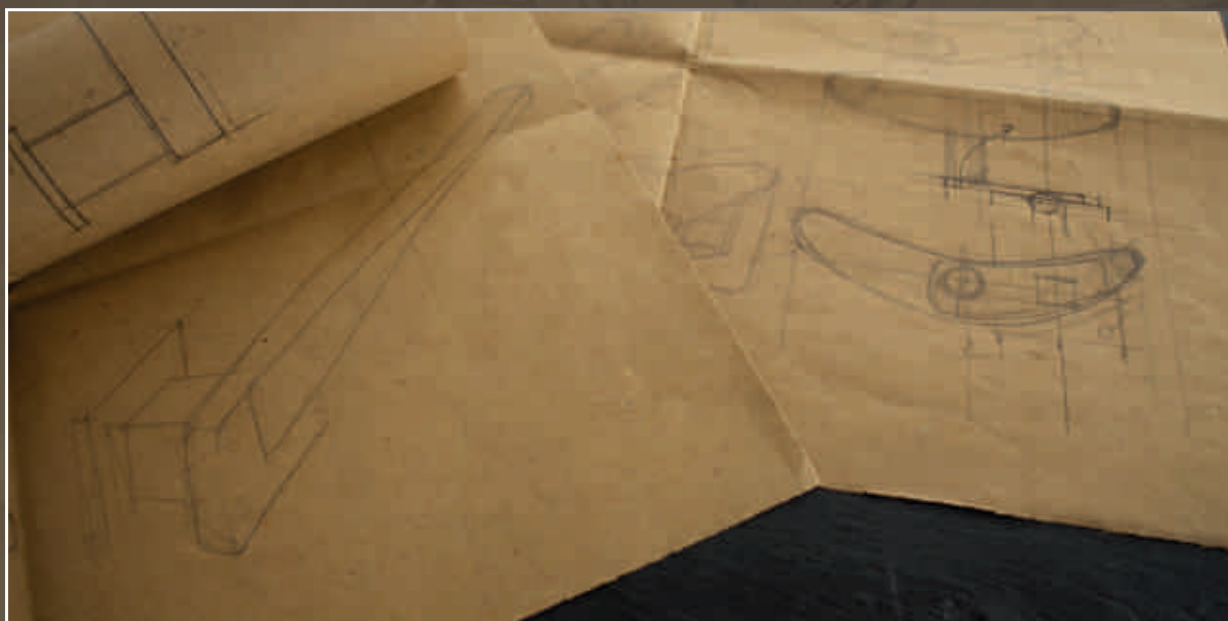







## AMIAMO IL VERDE

Abbiamo scelto di utilizzare per la nostra produzione, materie prime di qualità. Consapevoli del ruolo che le aziende al giorno d'oggi devono ricoprire per garantire una produzione eco-sostenibile, esigiamo il rispetto delle politiche ambientali e l'utilizzo di sostanze non nocive nei processi produttivi, in conformità con le politiche Europee. Siamo infatti consci che il futuro dei ns. figli dipende da noi, e ci adoperiamo perché possano crescere in un ambiente pulito.

*We chose to use for our production, quality materials. Aware of the role that companies nowadays must play to ensure a sustainable production, we demand the respect of environmental policies and the use of non-harmful substances in the production process, in accordance with European policies. Indeed, we are aware that the future of our children depends on us, and we work so that they can grow up in a clean environment.*







## CUSTOM MADE

Fimet si è sempre distinta per la costante ricerca di idee e soluzioni che possano soddisfare ogni tipo di richiesta, ed è proprio per questo impegno che siamo orgogliosi di presentare la ns. nuova sezione dedicata al CUSTOM MADE, il "fatto su misura". Solitamente ci proponiamo di creare soluzioni innovative adatte alle esigenze dei nostri singoli clienti per poi impostare una produzione in serie. L'obiettivo di questa nuova sezione è di offrire una soluzione alternativa mediante la creazione di maniglie uniche, studiate e pensate appositamente per i singoli mediante l'utilizzo di macchine a controllo numerico e lavorazione per le quali non è necessario sostenere i costi onerosi di uno stampo. Ci piace l'idea di essere in grado di fornire ai nostri clienti maniglie esclusive senza eguali che possano soddisfare appieno le loro esigenze estetiche e tecniche.

*Fimet has always stood for the constant search for ideas and solutions that can satisfy any kind of request, and it is through this commitment that we are proud to present our. new section dedicated to "CUSTOM MADE". Usually we aim to create innovative solutions tailored to the needs of our individual customers and then set up a series production. The objective of this new section is to provide an alternative solution by creating unique handles, studied and designed specifically for the individual through the use of numerical control machines and manufacturing for which it is not necessary to support the high costs of a mould. We like the 'idea of being able to provide our customers with unmatched exclusive handles that can fully satisfy their aesthetic and technical requirements.*











PORCELLANA

# TASHA 1028P

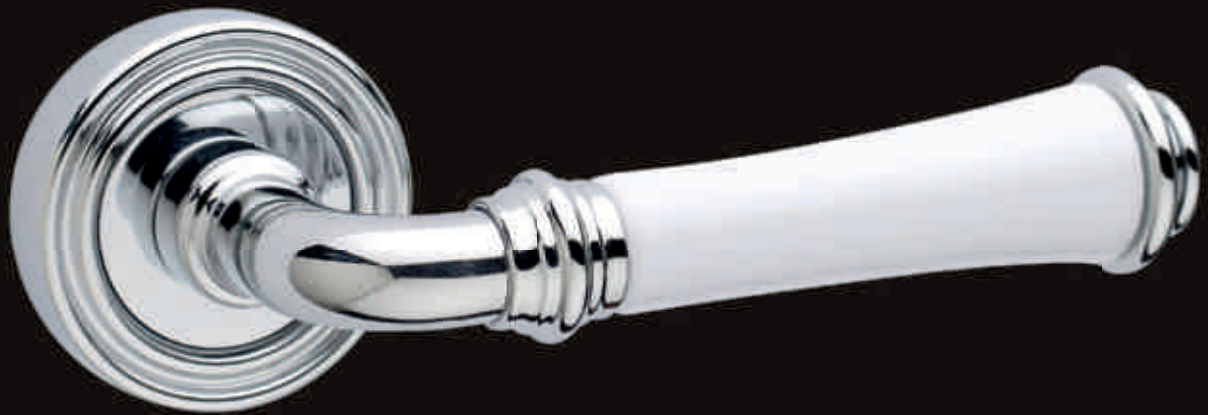





**1028P/261**

Maniglia con rosetta  
*Handle with rosette*

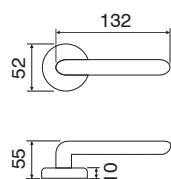

**1028P/288**

Maniglia con placca  
*Handle with plate*

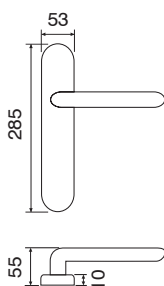

**1028P D.K.**

Maniglia anta ribalta  
*Tilt and turn handle*

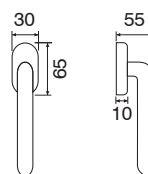

**1028P STG/261**

Maniglione  
*Pull-handle*

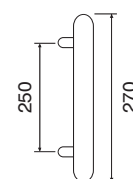

**1028P/261 - F04 White**

Cromo lucido  
*Polished chrome*



**1028P/261 - F45 White**

Ferro antico  
*Antique iron*



**1028P/261 - F43 White**

Bronzo graffiato opaco  
*Opaque satin bronze*

# ANASTASIA 198





**198/266**

Maniglia con rosetta  
*Handle with rosette*

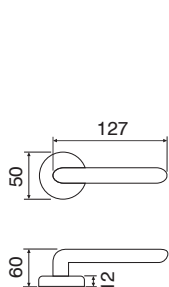

**198/270**

Maniglia con placca  
*Handle with plate*

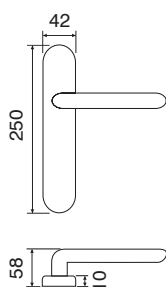

**198 D.K.**

Maniglia anta ribalta  
*Tilt and turn handle*

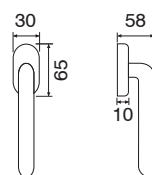

**198 STG/266**

Maniglione  
*Pull-handle*

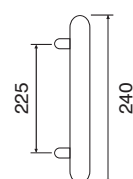

**198/266 - F04 White/Silver**

Cromo lucido  
*Polished chrome*



**198/266 - F01 White/Gold**

Ottone lucido  
*Polished brass*





**148/231C**

Maniglia con rosetta  
*Handle with rosette*

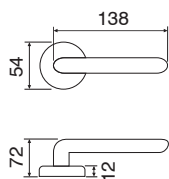

**148/275R**

Maniglia con placca  
*Handle with plate*

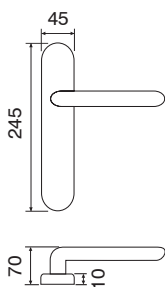

**148 D.K.**

Maniglia anta ribalta  
*Tilt and turn handle*

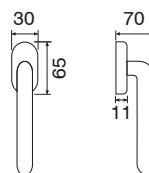

**148STG/231C**

Maniglione  
*Pull-handle*

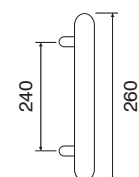

**148/231C - F21 Silver stripes**

Nickel lucido  
*Polished nickel*



**148/231C - F01 Gold stripes**

Ottone lucido  
*Polished brass*



**148/231C - F23 Sand**

Bronzo antico  
*Aged bronzed brass*



**148/231C - F45 Black stripes**

Ferro antico  
*Antique iron*







**147P/250F**

Maniglia con rosetta  
*Handle with rosette*

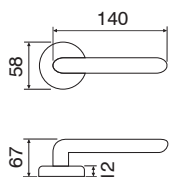

**147P/280**

Maniglia con placca  
*Handle with plate*

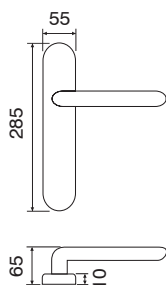

**147P D.K.**

Maniglia anta ribalta  
*Tilt and turn handle*

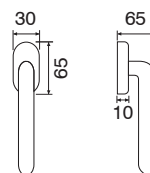

**147P STG/250F**

Maniglione  
*Pull-handle*

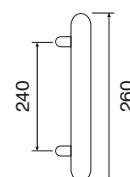

**147P/231C - F04 White/Silver**

Cromo lucido  
*Polished chrome*



**147P/231C - F01 White/Gold**

Ottone lucido  
*Polished brass*



**147P/231C - F04 Black/Silver**

Cromo lucido  
*Polished chrome*



# MICHELLE 106P

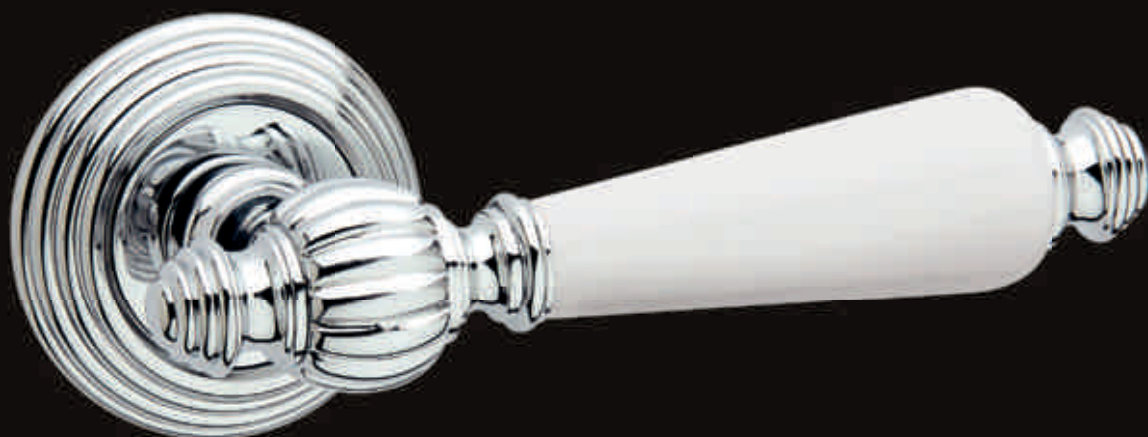



### 106P/269

Maniglia con rosetta  
*Handle with rosette*

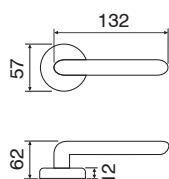

### 106P/288

Maniglia con placca  
*Handle with plate*

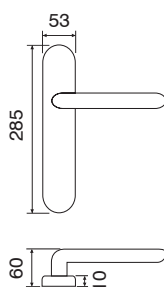

### 106P D.K.

Maniglia anta ribalta  
*Tilt and turn handle*

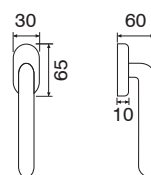

### 106P STG/269

Maniglione  
*Pull-handle*

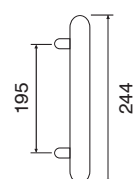

### 106P/269 - F.02O Beige

Effetto ottone satinato opaco  
*Opaque satin brass effect*



### 106P/269 - F43 Beige

Bronzo graffiato opaco  
*Opaque satin bronze*



### 106P/269 - F15 White

Antracite  
*Anthracite*



### 106P/269 - F43 White

Bronzo graffiato opaco  
*Opaque satin bronze*



### 106P/269 - F04 White

Cromo lucido  
*Polished chrome*



### 106P/269 - F21 Black

Nickel lucido  
*Polished nickel*



### 106P/269 - F45 Beige

Ferro antico  
*Antique iron*



### 106P/269 - F50 White

Bronzo scuro  
*Dark bronze*



### 106P/269 - F21 Black Flower

Nickel lucido  
*Polished nickel*





**142/231BT**

Maniglia con rosetta  
*Handle with rosette*

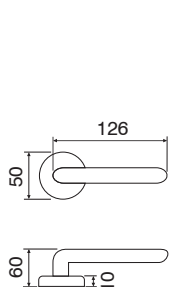

**142/202L**

Maniglia con placca  
*Handle with plate*

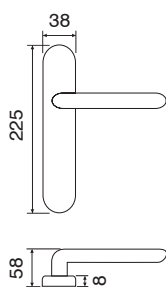

**142 D.K.**

Maniglia anta ribalta  
*Tilt and turn handle*

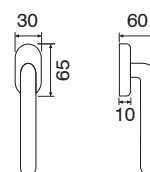

**142 STG/231BT**

Maniglione  
*Pull-handle*

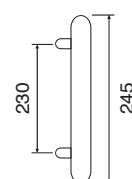

**142/231BT - F03 Crackle Beige**

Bronzo graffiato lucido  
*Shiny satin bronze*



**141/231BT - F03 White**

Bronzo graffiato lucido  
*Shiny satin bronze*



**143/231BT - F03 Beige**

Bronzo graffiato lucido  
*Shiny satin bronze*



**141/231BT - F01 White**

Ottone lucido  
*Polished brass*







**108/266**



**108/273**

Maniglia con rosetta  
*Handle with rosette*

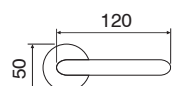

**108/266**

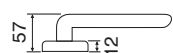

**108/273**



**108/274**

Maniglia con placca  
*Handle with plate*

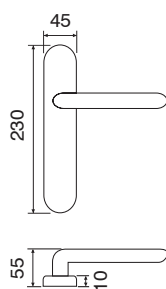

**108 D.K.**

Maniglia anta ribalta  
*Tilt and turn handle*



**108 STG/273**

Maniglione  
*Pull-handle*

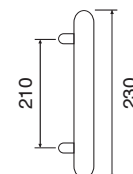

**108/273 - F01 White**

Ottone lucido  
*Polished brass*



**108/273 - F04 White**

Cromo lucido  
*Polished chrome*



**108/273 - F04 Black**

Cromo lucido  
*Polished chrome*



**108/273 - F43 White**

Bronzo graffiato opaco  
*Opaque satin bronze*



**108/273 - F45 Black**

Ferro antico  
*Antique iron*



# STONE 161S







### 161S/211BIC

Maniglia con rosetta  
*Handle with rosette*

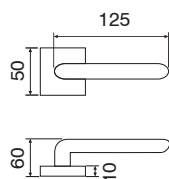

### 161S/210

Maniglia con placca  
*Handle with plate*

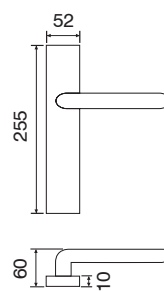

### 161S/211BIC - F04 White

Cromo lucido  
*Polished chrome*



### 161S/211BIC - F45 Grey

Ferro antico  
*Antique iron*



### 161S/211BIC - F01 Honey

Ottone lucido  
*Polished brass*



### 161S/211BIC - F03 Honey

Bronzo graffiato lucido  
*Shiny satin bronze*



# SQUARE P 160P

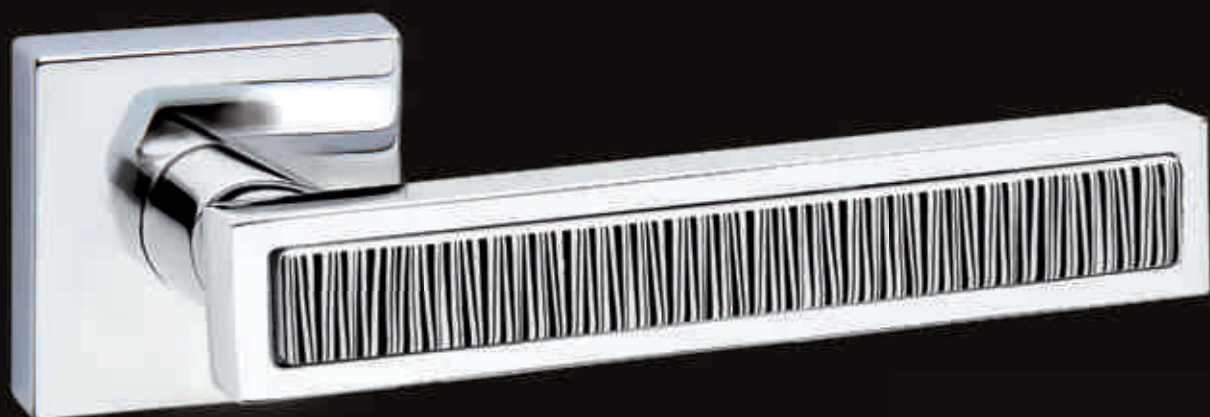



### 160P/201

Maniglia con rosetta  
*Handle with rosette*

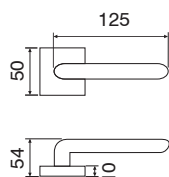

### 160P/210

Maniglia con placca  
*Handle with plate*

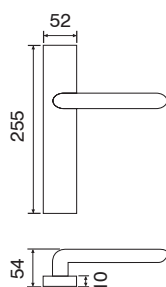

### 160P D.K.R.

Maniglia anta ribalta  
*Tilt and turn handle*

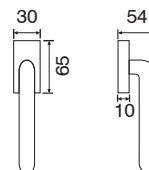

### 160P/201 - F04 Zebra

Cromo lucido  
*Polished chrome*



### 160P/201 - F04 White

Cromo lucido  
*Polished chrome*



### 160P/201 - F45 White

Ferro antico  
*Antique iron*



### 160P/201 - F21 Black

Nickel lucido  
*Polished nickel*



### 160P/201 - F55 Sand

Bronzo chiaro - Bronzo scuro  
*Light bronze - Dark bronze*





TIMELESS

---



# NICOLE 1377





### 1377/261

Maniglia con rosetta  
*Handle with rosette*

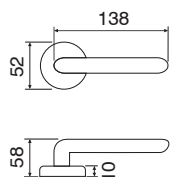

### 1377/257

Maniglia con placca  
*Handle with plate*

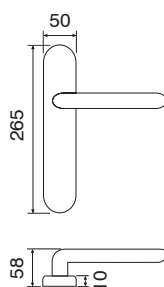

### 1377 D.K.

Maniglia anta ribalta  
*Tilt and turn handle*

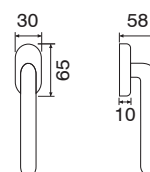

### 1377/261 - F04

Cromo lucido  
*Polished chrome*



### 1377/261 - F01

Ottone lucido  
*Polished brass*



### 1377/261 - F20

Nickel satinato  
*Satin nickel*



### 1377/261 - F.020

Effetto ottone satinato opaco  
*Opaque satin brass effect*



### 1377/261 - F43

Bronzo graffiato opaco  
*Opaque satin bronze*

# BLOSSOM 1378





### 1378/261

Maniglia con rosetta  
*Handle with rosette*

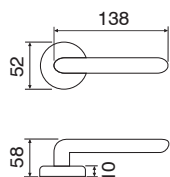

### 1378/257

Maniglia con placca  
*Handle with plate*

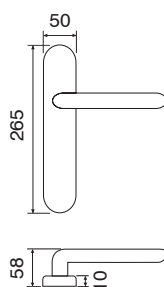

### 1378 D.K.

Maniglia anta ribalta  
*Tilt and turn handle*

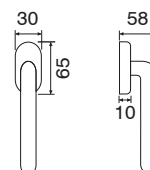

### 1378/261 - F58

Oro antico francese  
*Antique French gold*



### 1378/261 - F59

Argento antico francese  
*Antique French silver*



### 1378/261 - F21

Nickel lucido  
*Polished nickel*



### 1378/261 - F01

Ottone lucido  
*Polished brass*



### 1378/261 - F43

Bronzo graffiato opaco  
*Opaque satin bronze*



### 1378/261 - F17A

*Shabby chic*



### 1378/261 - F55

Bronzo chiaro - Bronzo scuro  
*Light bronze - Dark bronze*

# RETRÒ 1380







### 1380/240R

Maniglia con rosetta  
*Handle with rosette*

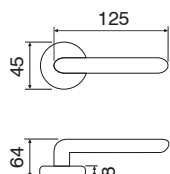

### 1380/259

Maniglia con placca  
*Handle with plate*

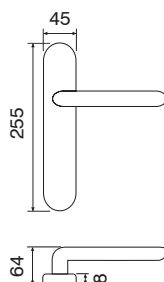

### 1380 D.K.

Maniglia anta ribalta  
*Tilt and turn handle*

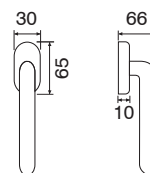

### 1380/240R - F04

Cromo lucido  
*Polished chrome*



### 1380/240R - F01

Ottone lucido  
*Polished brass*



### 1380/240R - F23

Bronzo antico  
*Aged bronzed brass*



### 1380/240R - F43

Bronzo graffiato opaco  
*Opaque satin bronze*

# DUFFY 1379





### 1379/266

Maniglia con rosetta  
*Handle with rosette*

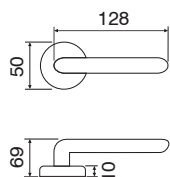

### 1379/257

Maniglia con placca  
*Handle with plate*

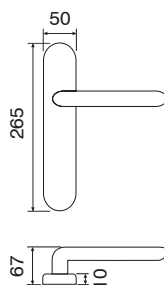

### 1379 D.K.

Maniglia anta ribalta  
*Tilt and turn handle*

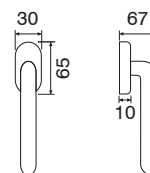

### 1379/266 - F04

Cromo lucido  
*Polished chrome*



### 1379/266 - F01

Ottone lucido  
*Polished brass*



### 1379/266 - F05

Cromo satinato  
*Satin chrome*



### 1379/266 - F23

Bronzo antico  
*Aged bronzed brass*



### 1379/266 - F43

Bronzo graffiato opaco  
*Opaque satin bronze*

# TASHA 1028







**1028/261**

Maniglia con rosetta  
*Handle with rosette*

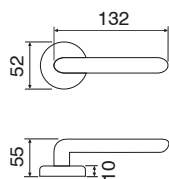

**1028/288**

Maniglia con placca  
*Handle with plate*

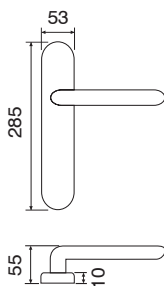

**1028 D.K.**

Maniglia anta ribalta  
*Tilt and turn handle*

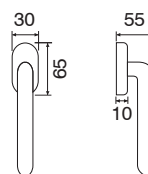

**1028 STG/261**

Maniglione  
*Pull-handle*

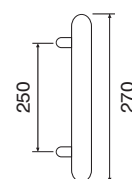

**1028/261 - F01**

Ottone lucido  
*Polished brass*



**1028/261 - F04**

Cromo lucido  
*Polished chrome*



**1028/261 - F20**

Nickel satinato  
*Satin nickel*



**1028/261 - F43**

Bronzo graffiato opaco  
*Opaque satin bronze*



**1028/261 - F45**

Ferro antico  
*Antique iron*



# MICHELLE 106

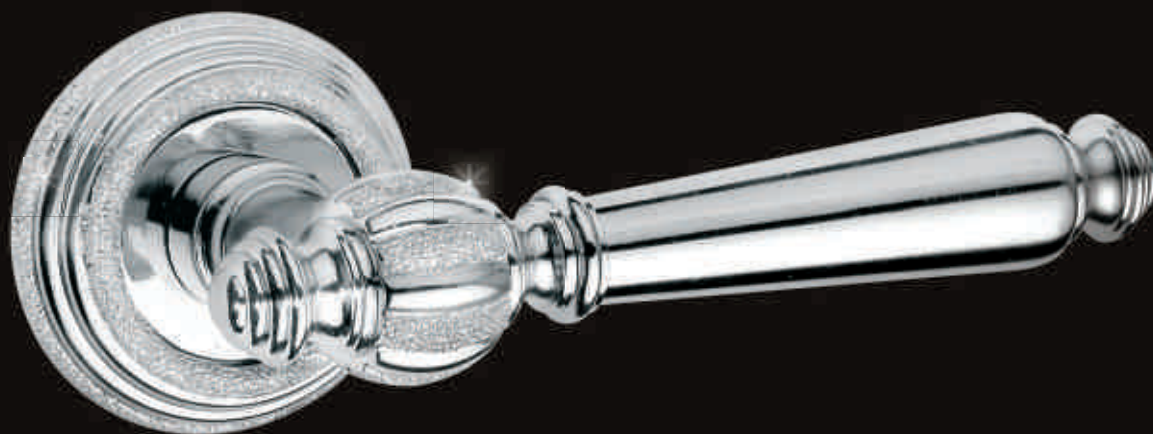



**106/269**

Maniglia con rosetta  
*Handle with rosette*

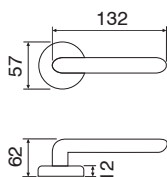

**106/288**

Maniglia con placca  
*Handle with plate*

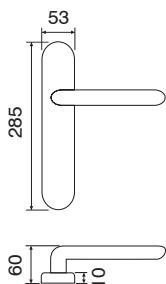

**106 D.K.**

Maniglia anta ribalta  
*Tilt and turn handle*

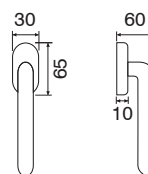

**106 STG/269**

Maniglione  
*Pull-handle*

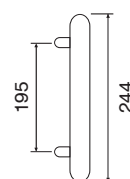

**106/269 - F102**

Argento - Pavè  
*Silver - Pavè*



**106/269 - F17A**

*Shabby chic*



**106/269 - F15**

Antracite  
*Anthracite*



**106/269 - F01**

Ottone lucido  
*Polished brass*



**106/269 - F21**

Nickel lucido  
*Polished nickel*



**106/269 - F66**

Cromo lucido - Cromo satinato  
*Polished chrome - Satin chrome*



**106/269 - F43**

Bronzo graffiato opaco  
*Opaque satin bronze*



**106/269 - F45**

Ferro antico  
*Antique iron*



**106/269 - F11**

Cromo lucido - Nickel satinato  
*Polished chrome - Satin nickel*



design registrato/registered design  
no. DM/083816







### 177/250F

Maniglia con rosetta  
*Handle with rosette*

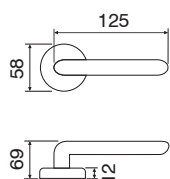

### 177/280

Maniglia con placca  
*Handle with plate*

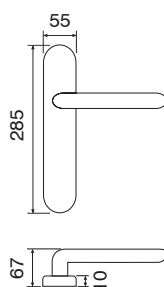

### 177 D.K.

Maniglia anta ribalta  
*Tilt and turn handle*

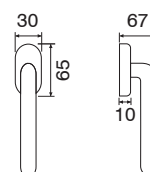

### 177/250F - F58

Oro antico francese  
*Antique French gold*



### 177/250F - F59

Argento antico francese  
*Antique French silver*



### 177/250F - F01

Ottone lucido  
*Polished brass*



### 177/250F - F04

Cromo lucido  
*Polished chrome*



### 177/250F - F17A

*Shabby chic*



### 177/250F - F55

Bronzo chiaro - Bronzo scuro  
*Light bronze - Dark bronze*



### 177/250F - F43

Bronzo graffiato opaco  
*Opaque satin bronze*



### 177/250F - F40

Cromo antico nero  
*Black aged chrome*



### 177/250F - F45

Ferro antico  
*Antique iron*

# ANNA ESSENCE 177.2



design registrato/registered design  
no. DM/083816





### 177.2 /258

Maniglia con rosetta  
*Handle with rosette*

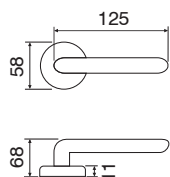

### 177.2 /270

Maniglia con placca  
*Handle with plate*

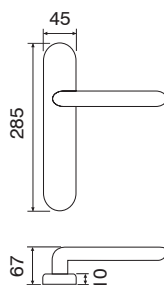

### 177.2 D.K.

Maniglia anta ribalta  
*Tilt and turn handle*

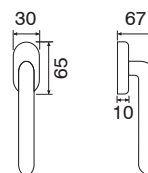

### 177.2 /258 - F01

Ottone lucido  
*Polished brass*



### 177.2 /258 - F10

Ottone lucido - Ottone satinato  
*Polished brass - Satin brass*



### 177.2 /258 - F43

Bronzo graffiato opaco  
*Opaque satin bronze*



### 177.2 /258 - F04

Cromo lucido  
*Polished chrome*



### 177.2 /258 - F21

Nickel lucido  
*Polished nickel*



### 177.2 /258 - F11

Nickel satinato - Nickel lucido  
*Satin nickel - Polished nickel*



### 177.2 /258 - F55

Bronzo chiaro - Bronzo scuro  
*Light bronze - Dark bronze*



### 177.2 /258 - F23

Bronzo antico  
*Aged bronzed brass*



### 177.2 /258 - F45

Ferro antico  
*Antique iron*







**147/250F**



**147/266**

Maniglia con rosetta  
*Handle with rosette*

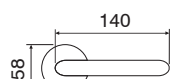

**147/250F**

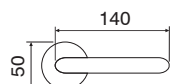
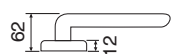

**147/266**

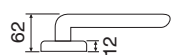

**147/280**

Maniglia con placca  
*Handle with plate*

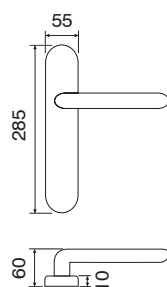

**147 D.K.**

Maniglia anta ribalta  
*Tilt and turn handle*



**147STG/250F**

Maniglione  
*Pull-handle*

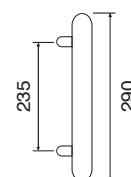

**147/250F - F59**

Argento antico francese  
*Antique French silver*



**147/250F - F58**

Oro antico francese  
*Antique French gold*



**147/250F - F40**

Cromo antico nero  
*Black aged chrome*



**147/266 - F21**

Nickel lucido  
*Polished nickel*



**147/266 - F43**

Bronzo graffiato opaco  
*Opaque satin bronze*



**147/266 - F45**

Ferro antico  
*Antique iron*





**105/265**

Maniglia con rosetta  
*Handle with rosette*

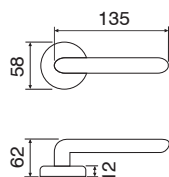

**105/280**

Maniglia con placca  
*Handle with plate*

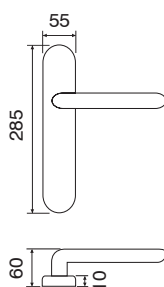

**105 D.K.**

Maniglia anta ribalta  
*Tilt and turn handle*

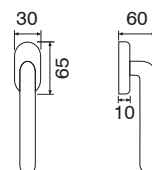

**105 STG/265**

Maniglione  
*Pull-handle*

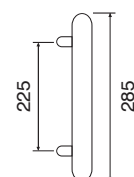

**105/269 - F21**

Nickel lucido  
*Polished nickel*



**105/269 - F43**

Bronzo graffiato opaco  
*Opaque satin bronze*



**105/269 - F45**

Ferro antico  
*Antique iron*

# VITTORIA 173







**173/265**

Maniglia con rosetta  
*Handle with rosette*

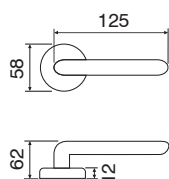

**173/288**

Maniglia con placca  
*Handle with plate*

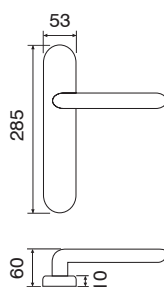

**173 D.K.**

Maniglia anta ribalta  
*Tilt and turn handle*

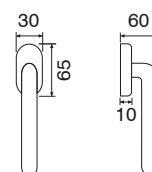

**173/266 - F21**

Nickel lucido  
*Polished nickel*



**173/266 - F02**

Ottone satinato  
*Satin brass*



**173/266 - F43**

Bronzo graffiato opaco  
*Opaque satin bronze*



**173/266 - F45**

Ferro antico  
*Antique iron*



**173/266 - F55**

Bronzo chiaro - Bronzo scuro  
*Light bronze - Dark bronze*



**173/266 - F N.O.**

Nero opaco  
*Opaque black*





**172/269**

Maniglia con rosetta  
*Handle with rosette*

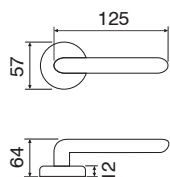

**172/288**

Maniglia con placca  
*Handle with plate*

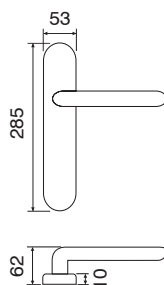

**172 D.K.**

Maniglia anta ribalta  
*Tilt and turn handle*

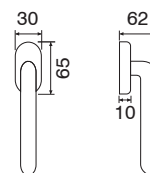

**172/269 - F43**

Bronzo graffiato opaco  
*Opaque satin bronze*



**172/269 - F02**

Ottone satinato  
*Satin brass*



**172/269 - F55**

Bronzo chiaro - Bronzo scuro  
*Light bronze - Dark bronze*



**172/269 - F21**

Nickel lucido  
*Polished nickel*



**172/269 - F45**

Ferro antico  
*Antique iron*







**109/294**



**109/266**

Maniglia con rosetta  
*Handle with rosette*

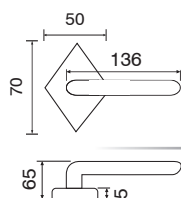

**109/294**

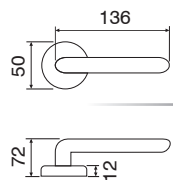

**109/266**



**109/293**

Maniglia con placca  
*Handle with plate*

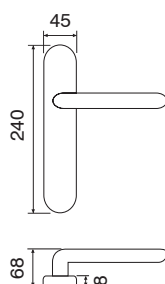

**109 D.K.**

Maniglia anta ribalta  
*Tilt and turn handle*

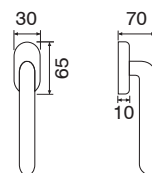

**3293**

Maniglione  
*Pull-handle*

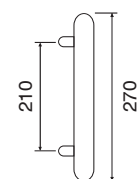

**109/266 - F23**

Bronzo antico  
*Aged bronzed brass*



**109/266 - F03**

Ottone bronzato  
*Shiny bronze*



**109/266 - F43**

Bronzo graffiato opaco  
*Opaque satin bronze*



**109/266 - F01**

Ottone lucido  
*Polished brass*



**109/266 - F21**

Nickel lucido  
*Polished nickel*



**109/266 - F45**

Ferro Antico  
*Antique iron*



# JULIETTE 152





**152/231C**



**152/231BT**

Maniglia con rosetta  
*Handle with rosette*

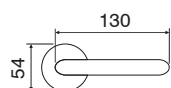

**152/231C**

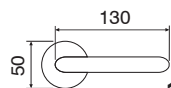
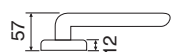

**152/231BT**



**152/275R**

Maniglia con placca  
*Handle with plate*

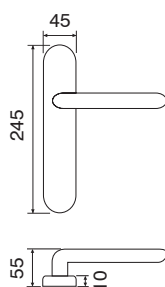

**152 D.K.**

Maniglia anta ribalta  
*Tilt and turn handle*



**152 STG/231C**

Maniglione  
*Pull-handle*

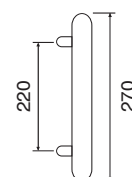

**152/231C - F01**

Ottone lucido  
*Polished brass*



**152/231C - F10**

Ottone lucido - Ottone satinato  
*Polished brass - Satin brass*



**152/231C - F43**

Bronzo graffiato opaco  
*Opaque satin bronze*



**152/231C - F45**

Ferro antico  
*Antique iron*

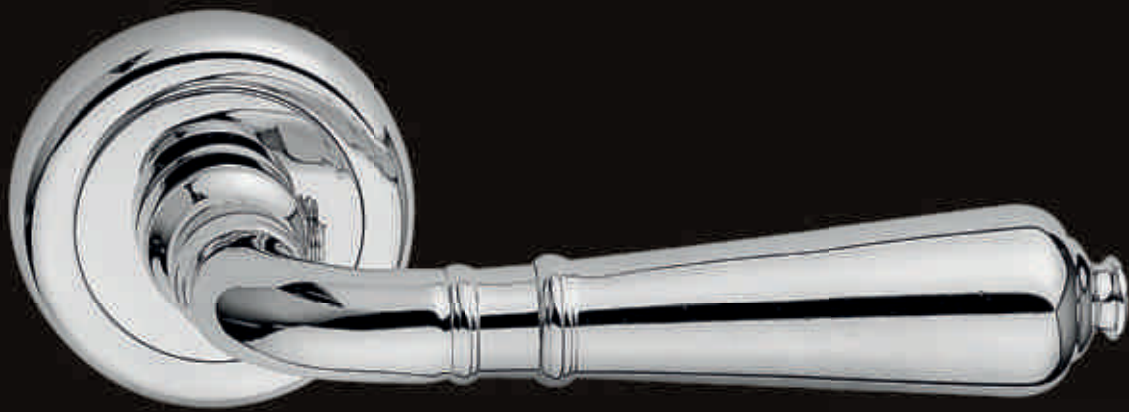





**154/266**

Maniglia con rosetta  
*Handle with rosette*

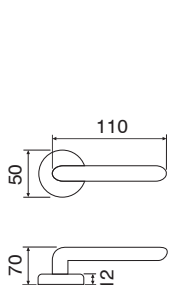

**154/205**

Maniglia con placca  
*Handle with plate*

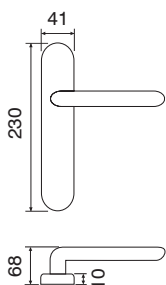

**154 D.K.**

Maniglia anta ribalta  
*Tilt and turn handle*

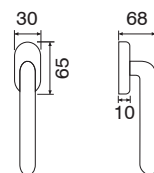

**154 STG/266**

Maniglione  
*Pull-handle*

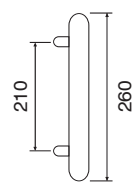

**154/231BT - F01**

Ottone lucido  
*Polished brass*



**154/231BT - F04**

Cromo lucido  
*Polished chrome*



**154/231BT - F43**

Bronzo graffiato opaco  
*Opaque satin bronze*



**154/231BT - F03**

Bronzo graffiato lucido  
*Shiny satin bronze*



**154/231BT - F23**

Bronzo antico  
*Aged bronzed brass*



**154/231BT - F N.O.**

Nero opaco  
*Opaque black*



**154/231BT - F45**

Ferro Antico  
*Antique iron*



# CALLIOPE 151





### 151/266

Maniglia con rosetta  
*Handle with rosette*

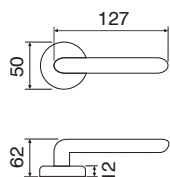

### 151/274

Maniglia con placca  
*Handle with plate*

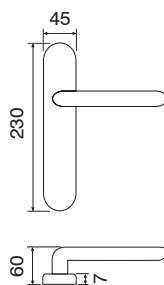

### 151 D.K.

Maniglia anta ribalta  
*Tilt and turn handle*

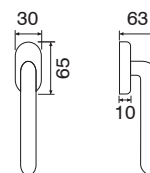

### 151/273 - F01

Ottone lucido  
*Polished brass*



### 151/273 - F04

Cromo lucido  
*Polished chrome*



### 151/273 - F45

Ferro antico  
*Antique iron*



### 151/273 - F43

Bronzo graffiato opaco  
*Opaque satin bronze*



### 151/273 - F23

Bronzo antico  
*Aged bronzed brass*



### 151/273 - F05

Cromo satinato  
*Satin chrome*



### 151/273 - F20

Nickel satinato  
*Satin nickel*







**119/233**



**119/266**

Maniglia con rosetta  
*Handle with rosette*



**119/248R**

Maniglia con placca  
*Handle with plate*



**119 D.K.**

Maniglia anta ribalta  
*Tilt and turn handle*



**119 STG/266**

Maniglione  
*Pull-handle*

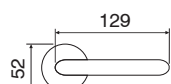

**119/233**

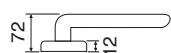

**119/266**

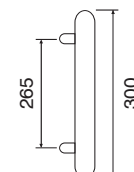
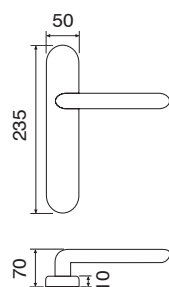
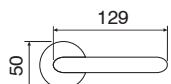

**119/233 - F04**

Cromo lucido  
*Polished chrome*



**119/233 - F01**

Ottone lucido  
*Polished brass*



**119/233 - F21**

Nickel lucido  
*Polished nickel*



**119/233 - F05**

Cromo lucido - cromo satinato  
*Polished chrome - satin chrome*



**119/233 - F05**

Cromo satinato  
*Satin chrome*



**119/233 - F43**

Bronzo graffiato opaco  
*Opaque satin bronze*





### 178/233

Maniglia con rosetta  
*Handle with rosette*

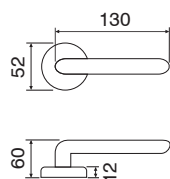

### 178/248P

Maniglia con placca  
*Handle with plate*

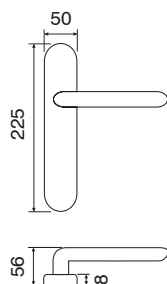

### 178 D.K.

Maniglia anta ribalta  
*Tilt and turn handle*

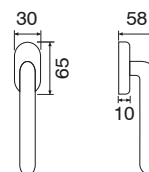

### 178/273 - F04

Cromo lucido  
*Polished chrome*



### 178/273 - F01

Ottone lucido  
*Polished brass*



### 178/273 - F45

Ferro antico  
*Antique iron*







### 138/233

Maniglia con rosetta  
*Handle with rosette*

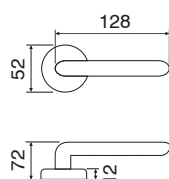

### 138/248R

Maniglia con placca  
*Handle with plate*

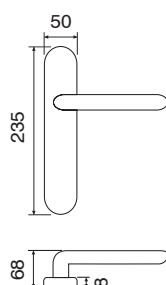

### 138 D.K.

Maniglia anta ribalta  
*Tilt and turn handle*

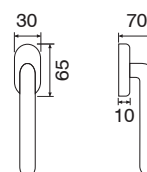

### 138/233 - F04

Cromo lucido  
*Polished chrome*



### 138/233 - F01

Ottone lucido  
*Polished brass*





### 157/232

Maniglia con rosetta  
*Handle with rosette*

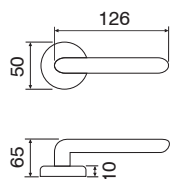

### 157/275

Maniglia con placca  
*Handle with plate*

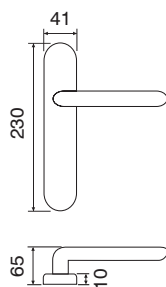

### 157 D.K.

Maniglia anta ribalta  
*Tilt and turn handle*

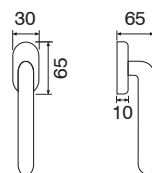

#### 157/232 - F01

Ottone lucido  
*Polished brass*



#### 157/232 - F04

Cromo lucido  
*Polished chrome*



#### 157/232 - F05

Cromo satinato  
*Satin chrome*



#### 157/232 - F54

Effetto nickel satinato verniciato opaco  
*Opaque satin nickel effect*



# EAGLE 150







### 150/232

Maniglia con rosetta  
*Handle with rosette*

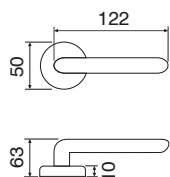

### 150/275R

Maniglia con placca  
*Handle with plate*

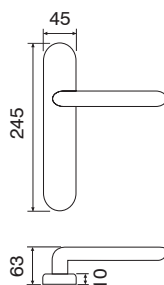

### 150 D.K.

Maniglia anta ribalta  
*Tilt and turn handle*

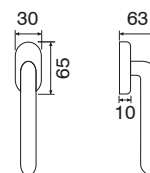

#### 150/232 - F01

Ottone lucido  
*Polished brass*



#### 150/232 - F04

Cromo lucido  
*Polished chrome*



#### 150/232 - F05

Cromo satinato  
*Satin chrome*



#### 150/232 - F54

Effetto nickel satinato verniciato opaco  
*Opaque satin nickel effect*





### 156/231C

Maniglia con rosetta  
*Handle with rosette*

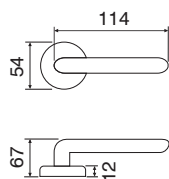

### 156/275R

Maniglia con placca  
*Handle with plate*

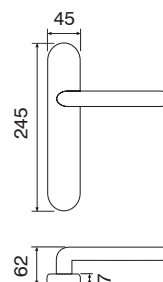

### 156/231C - F01

Ottone lucido  
*Polished brass*



### 156/231C - F55

Bronzo chiaro - Bronzo scuro  
*Light bronze - Dark bronze*



### 156/231C - F04

Cromo lucido  
*Polished chrome*



DUCK 153







**153/273**

Maniglia con rosetta  
*Handle with rosette*

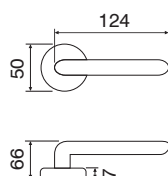

**153/273 - F01**

Ottone lucido  
*Polished brass*



**153/228**

Maniglia con placca  
*Handle with plate*

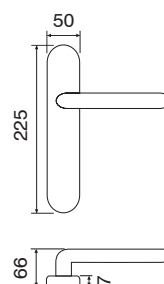

**153/273 - F03**

Bronzo graffiato lucido  
*Shiny satin bronze*

# STEFANIA 195



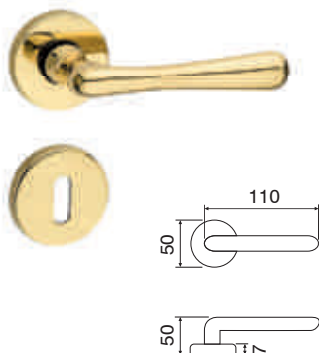

**195/273**

Maniglia con rosetta  
*Handle with rosette*

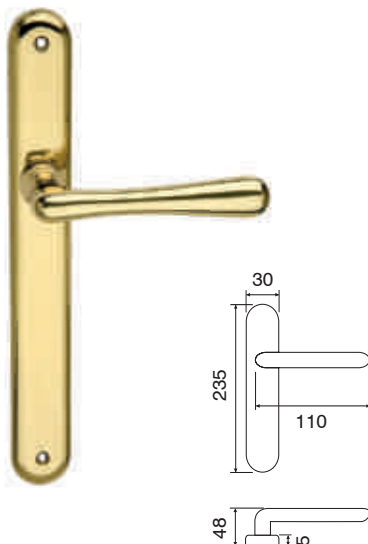

**195/217**

Maniglia con placca  
*Handle with plate*

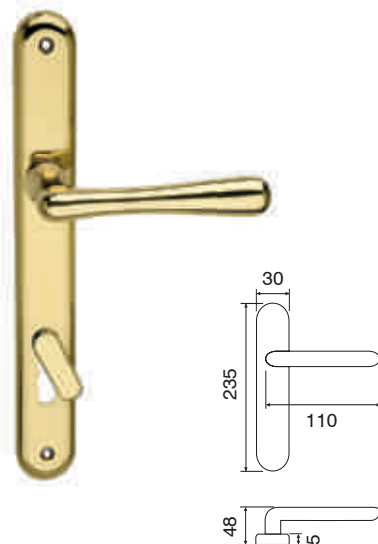

**195/217S**

Maniglia con placca  
*Handle with plate*

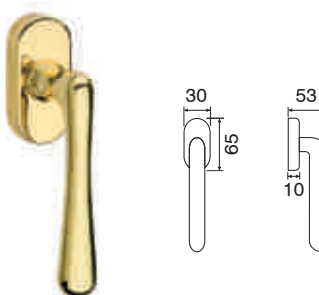

**195 DK**

Maniglia anta ribalta  
*Tilt and turn handle*

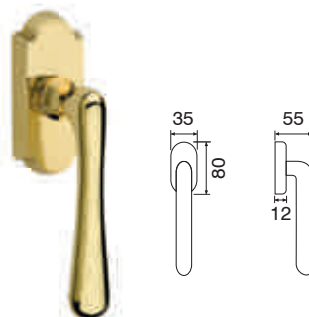

**195 DK.A**

Maniglia anta ribalta  
*Tilt and turn handle*  
*Rasterolive DK.A*

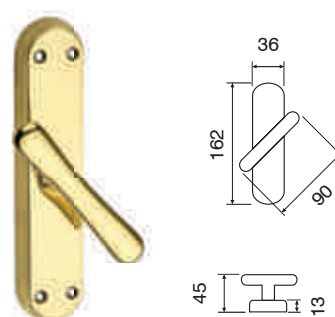

**195C**

Cremonese  
*Window handle*



**195C DK**

Martellina  
*Half handle on rose*



**195C DKA**

Martellina  
*Half handle on rose*



**195C/272**

Martellina  
*Half handle on rose*



**195M**

Martellina  
*Half handle on rose*

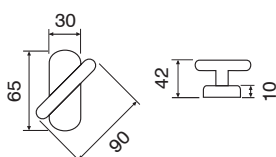

**195 - F01**

Ottone lucido  
*Polished brass*

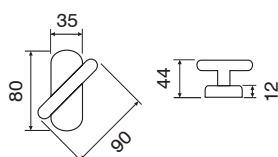

**195 - F04**

Cromo lucido  
*Polished chrome*

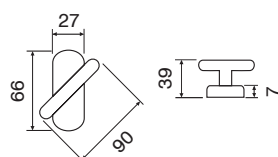

**195 - F05**

Cromo satinato  
*Satin chrome*

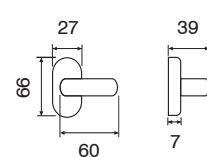

**195 - F03**

Bronzo graffiato lucido  
*Shiny satin bronze*





**196/273**

Maniglia con rosetta  
*Handle with rosette*

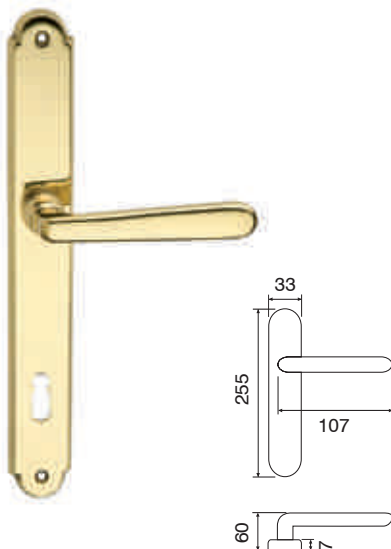

**196/250A**

Maniglia con placca  
*Handle with plate*

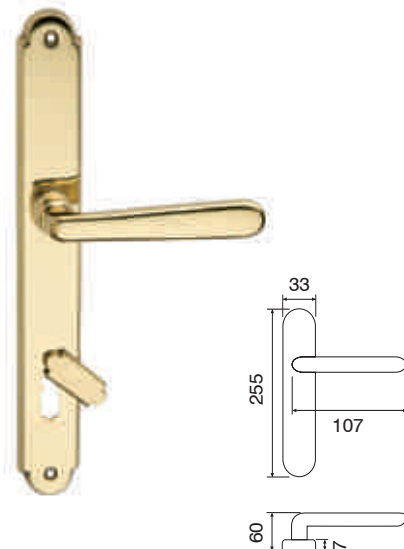

**196/250AS**

Maniglia con placca  
*Handle with plate*

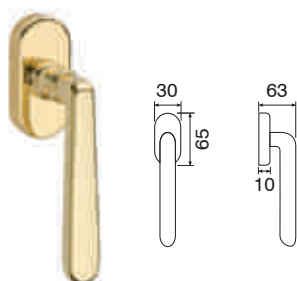

**196 DK**

Maniglia anta ribalta  
*Tilt and turn handle*

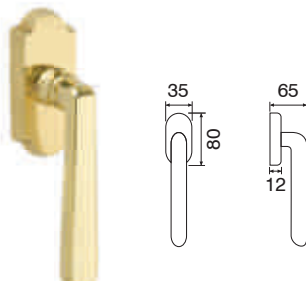

**196 DK.A**

Maniglia anta ribalta  
*Tilt and turn handle*  
*Rasterolive DK.A*

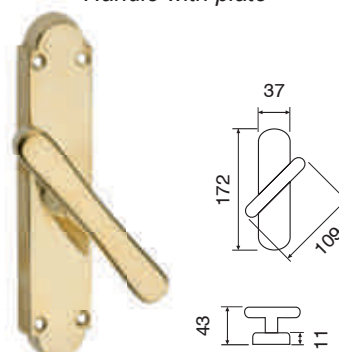

**196C**

Cremonese  
*Window handle*



**196C DK**

Martellina  
*Half handle on rose*



**196C DKA**

Martellina  
*Half handle on rose*



**196C 272**

Martellina  
*Half handle on rose*



**196M**

Martellina  
*Half handle on rose*

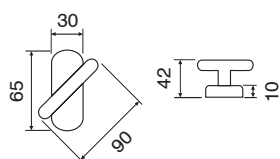

**196 - F01**

Ottone lucido  
*Polished brass*

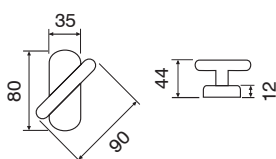

**196 - F04**

Cromo lucido  
*Polished chrome*

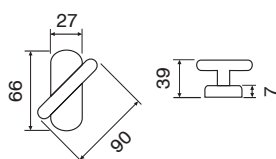

**196 - F05**

Cromo satinato  
*Satin chrome*

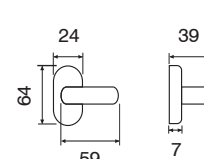

**196 - F03**

Bronzo graffiato lucido  
*Shiny satin bronze*







PELLE

---

# BAU 137L

## 137L/211B F04 Rosso

Maniglia con rosetta  
Handle with rosette

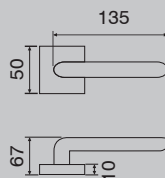

## 137L/232 F04 Rosso

Maniglia con rosetta  
Handle with rosette

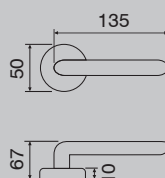

## 137L STG/232 F04 Rosso

Maniglione  
Pull-handle

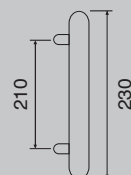

# BAU 137L

## 137L/211B F04 Nero tecnico

Maniglia con rosetta  
Handle with rosette

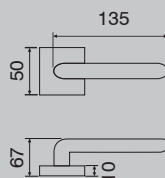

## 137L/232 F04 Nero tecnico

Maniglia con rosetta  
Handle with rosette

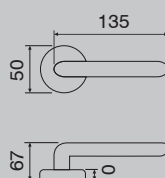

## 137L STG/232 F04 Nero tecnico

Maniglione  
Pull-handle

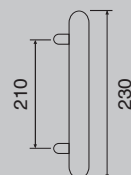

# X 1028L

## 1028L/261 F04 Bianco

Maniglia con rosetta  
Handle with rosette

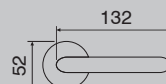

## 1028L/261 F01 Testa di moro

Maniglia con rosetta  
Handle with rosette

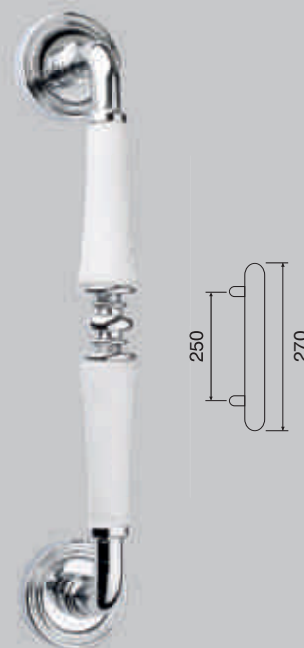

## 1028L STG/261 F04 Bianco

Maniglione  
Pull-handle

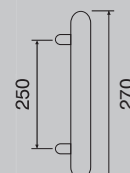

# X 106L

## 106L/269 F05 Blu

Maniglia con rosetta  
Handle with rosette



## 106L/269 F01 Tortora

Maniglia con rosetta  
Handle with rosette

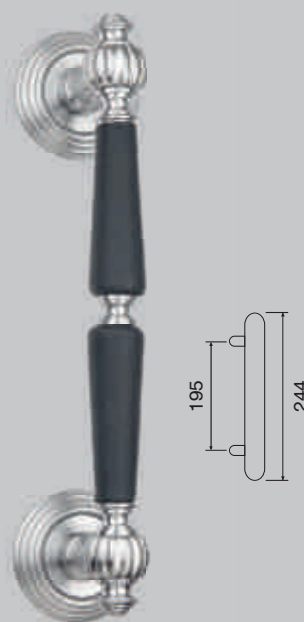

## 106L STG/269 F05 Blu

Maniglione  
Pull-handle

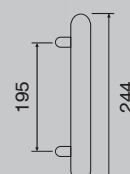



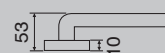
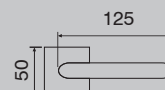

**160.3/201**  
**F04 Nero**

Maniglia con rosetta  
*Handle with rosette*



**160.3/201**  
**F04 Bianco**

Maniglia con rosetta  
*Handle with rosette*

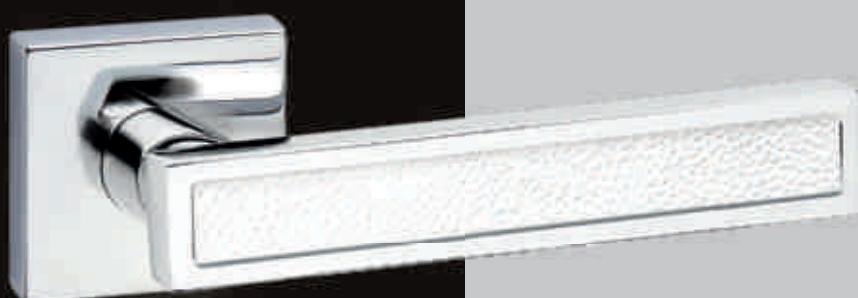

**160.3/201**  
**F04 Cuoio**

Maniglia con rosetta  
*Handle with rosette*



**160.3/201**  
**F04 Testa di moro**

Maniglia con rosetta  
*Handle with rosette*





# 193

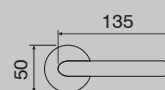

**193/232**  
**F04 Nero**

Maniglia con rosetta  
*Handle with rosette*



**193/232**  
**F01 Cuoio**

Maniglia con rosetta  
*Handle with rosette*



# 112

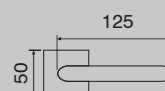

**112/201**  
**F04 Nero**

Maniglia con rosetta  
*Handle with rosette*

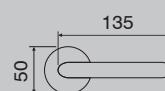

**112/232**  
**F04 Bordeaux**

Maniglia con rosetta  
*Handle with rosette*





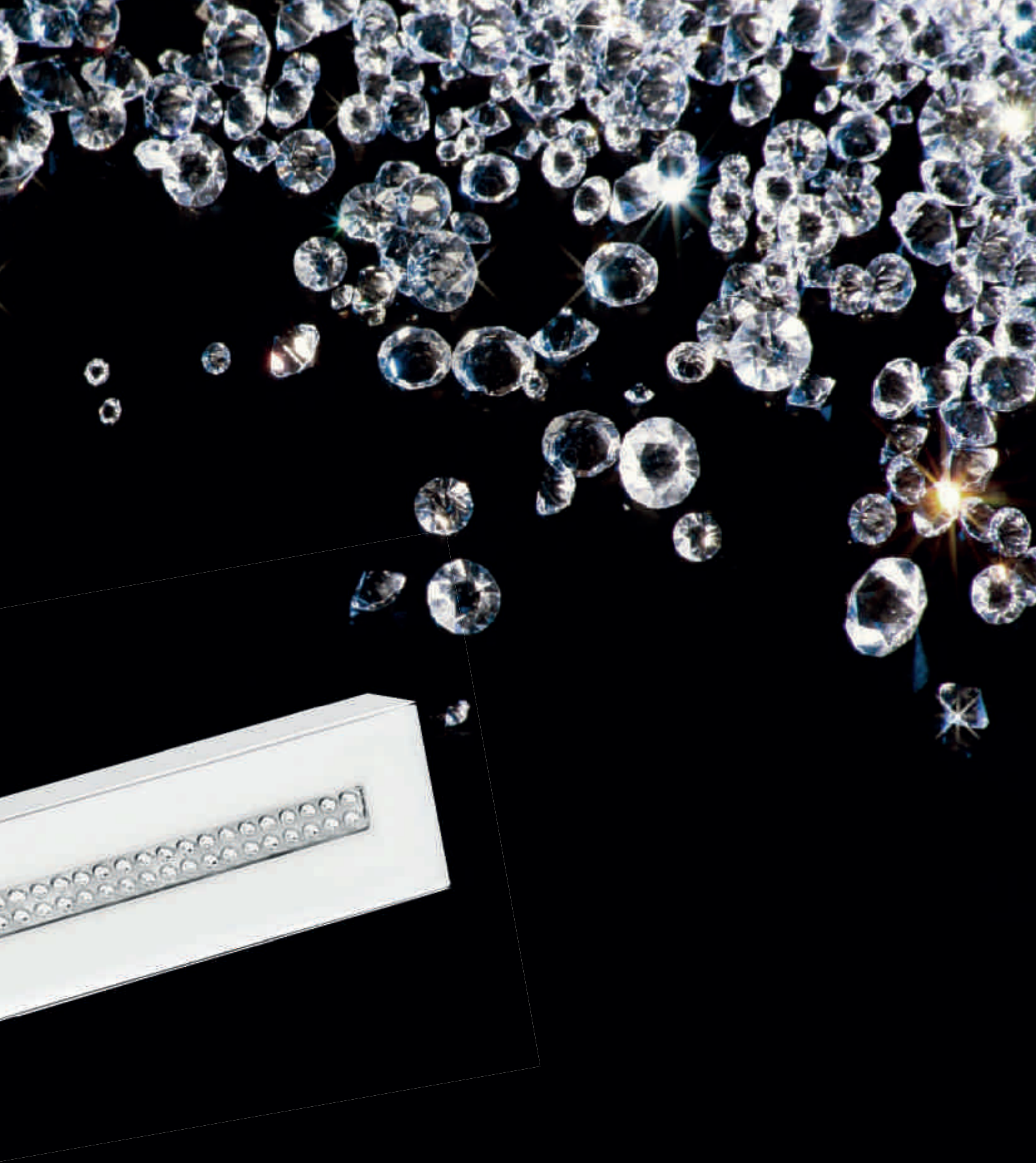

SWAROVSKI







**160S.1/201 - F04S**

Cromo lucido/Swarovski  
Polished chrome/Swarovski

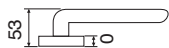
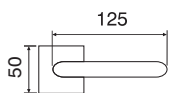

**160S.3/201 - F04S**

Cromo lucido/Swarovski  
Polished chrome/Swarovski

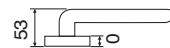
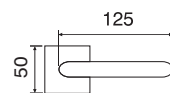

**160S.2/201 - F04S**

Cromo lucido/Swarovski  
Polished chrome/Swarovski

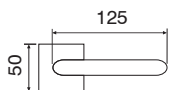

**164F/201 - F04S**

Cromo lucido/Swarovski  
Polished chrome/Swarovski

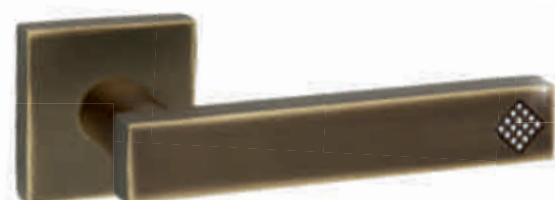
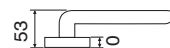
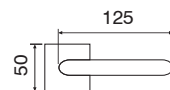

**164F/201 - F55S**

Bronzo chiaro - Bronzo scuro/Swarovski  
Light bronze - Dark bronze/Swarovski

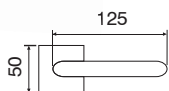

**160S.2/201 - F55S**

Bronzo chiaro - Bronzo scuro/Swarovski  
Light bronze - Dark bronze/Swarovski

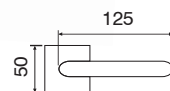

**160S.3/201 - F55S**

Bronzo chiaro - Bronzo scuro/Swarovski  
Light bronze - Dark bronze/Swarovski

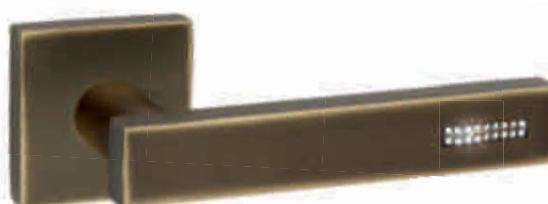
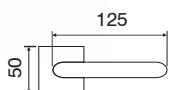

**160S.1/201 - F55S**

Bronzo chiaro - Bronzo scuro/Swarovski  
Light bronze - Dark bronze/Swarovski

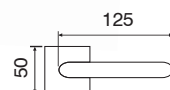



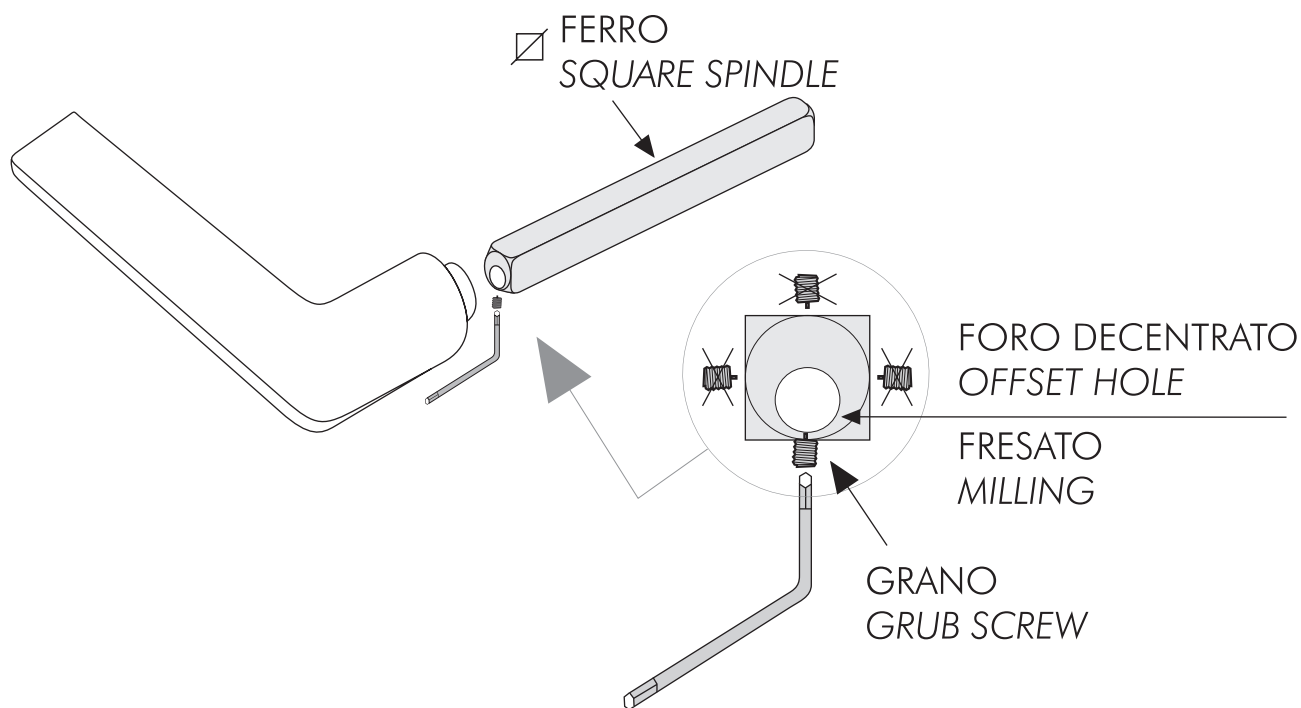

ART. 273

## ASSEMBLY SYSTEM A

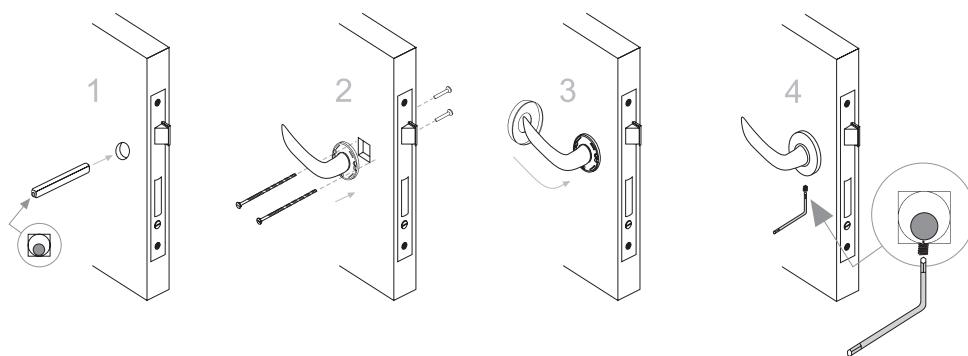

- 1) Inserire il ferro quadro nella serratura, rivolgendo la fresata o il foro verso la posizione del foro grano presente sulla maniglia.
- 2) Posizionare la maniglia montata sulla sotto-rosetta in plastica e fissare con le viti in dotazione.
- 3) Posizionare la copertina a pressione sulla sotto-rosetta.
- 4) Avvitare il grano della maniglia nell'apposito foro finché non si blocca.

- 1) Insert the square spindle into the lock. The square spindle's milling or the hole has to be pointed to the handle's grub screw hole.
- 2) The handle, mounted on the plastic under-rose, must be positioned on the door, and fastened with the screws.
- 3) Clip the cover rose on the under-rose.
- 4) Fasten the grub screw in the handle's designated hole, until it stops.

## ASSEMBLY SYSTEM B

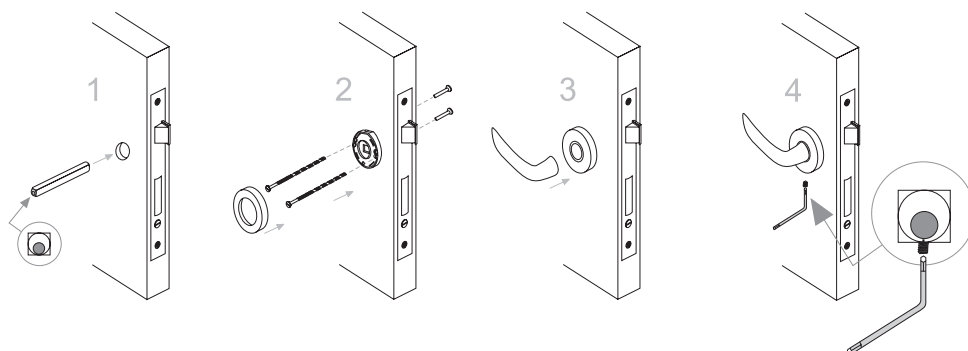

- 1) Inserire il ferro quadro nella serratura, rivolgendo la fresata o il foro verso la posizione del foro grano presente sulla maniglia.
- 2) Posizionare la sotto-rosetta (provvista di molla incorporata) in asse con il ferro quadro, fissare con le viti in dotazione. Dopodiché, posizionare la copertina a pressione sulla sotto-rosetta.
- 3) Posizionare la maniglia.
- 4) Avvitare il grano della maniglia nell'apposito foro finché non si blocca.

- 1) Insert the square spindle into the lock. The square spindle's milling or the hole has to be pointed to the handle's grub screw hole.
- 2) Position the built-in spring under-rose aligned with the square spindle, then fasten with the screws. Clip the cover rose on the under-rose.
- 3) Position the handle.
- 4) Fasten the grub screw in the handle's designated hole, until it stops.

## ART. 201 - 211B - 215

## ASSEMBLY SYSTEM C

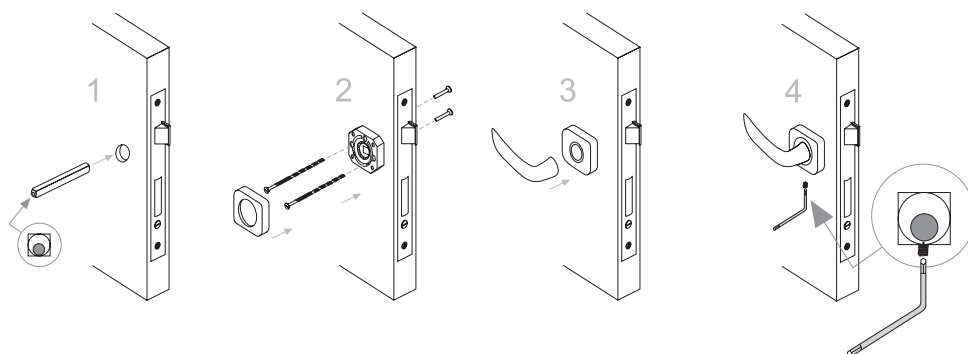

- 1) Inserire il ferro quadro nella serratura, rivolgendo la fresata o il foro verso la posizione del foro grano presente sulla maniglia.
- 2) Posizionare la sotto-rosetta (provvista di molla incorporata) in asse con il ferro quadro, fissare con le viti in dotazione. Dopodiché, posizionare la copertina a pressione sulla sotto-rosetta.
- 3) Posizionare la maniglia.
- 4) Avvitare il grano della maniglia nell'apposito foro finché non si blocca.

- 1) Insert the square spindle into the lock. The square spindle's milling or the hole has to be pointed to the handle's grub screw hole.
- 2) Position the built-in spring under-rose aligned with the square spindle, then fasten with the screws. Clip the cover rose on the under-rose.
- 3) Position the handle.
- 4) Fasten the grub screw in the handle's designated hole, until it stops.

## ASSEMBLY SYSTEM D

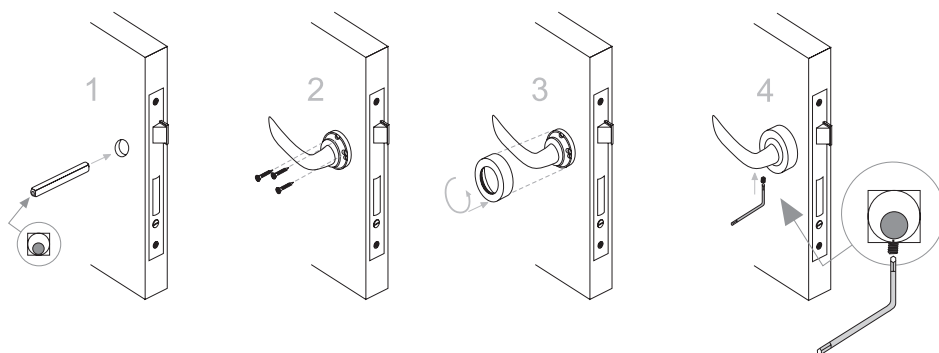

- 1) Inserire il ferro quadro nella serratura, rivolgendo la fresata o il foro verso la posizione del foro grano presente sulla maniglia.
- 2) Posizionare la maniglia montata sulla rosetta interna in metallo e fissare con le viti in dotazione.
- 3) Avvitare l'anello sulla rosetta interna.
- 4) Avvitare il grano della maniglia nell'apposito foro finché non si blocca.

- 1) Insert the square spindle into the lock. The square spindle's milling or the hole has to be pointed to the handle's grub screw hole.
- 2) The handle, mounted on the inner metal rose, must be positioned on the door, and fastened with the screws.
- 3) Screw the ring on the inner rose.
- 4) Fasten the grub screw in the handle's designated hole, until it stops.

## ART. 211BIC

## ASSEMBLY SYSTEM E

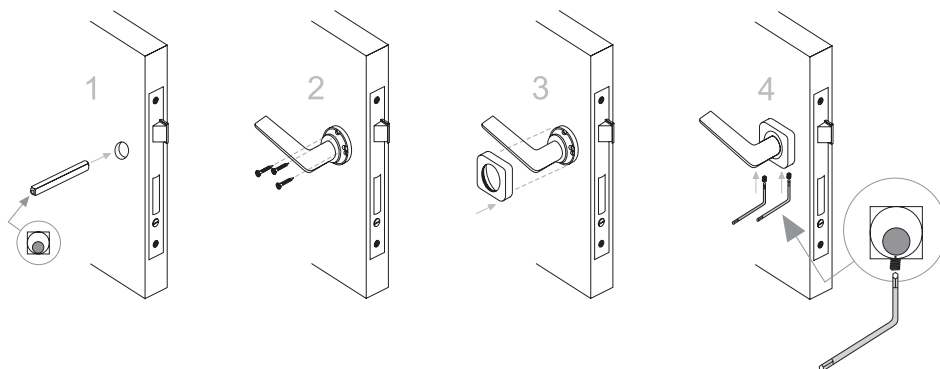

- 1) Inserire il ferro quadro nella serratura, rivolgendo la fresata o il foro verso la posizione del foro grano presente sulla maniglia.
- 2) Posizionare la maniglia montata sulla rosetta interna in metallo e fissare con le viti in dotazione.
- 3) Posizionare l'anello quadrato sulla rosetta interna, facendo particolare attenzione a mantenere la posizione in asse e il foro grano nella parte inferiore.
- 4) Fissare l'anello con il grano finché non si blocca. Avvitare il grano nell'apposito foro della maniglia finché non si blocca.

- 1) Insert the square spindle into the lock. The square spindle's milling or the hole has to be pointed to the handle's grub screw hole.
- 2) The handle, mounted on the inner metal rose, must be positioned on the door, and fastened with the screws.
- 3) Position the square ring on the inner rose. Position has to be aligned and ring's grub screw hole has to stay in the lower part.
- 4) Fasten the ring's grub screw until it stops. Fasten the grub screw in the handle's designated hole, until it stops.

## ASSEMBLY SYSTEM MINI

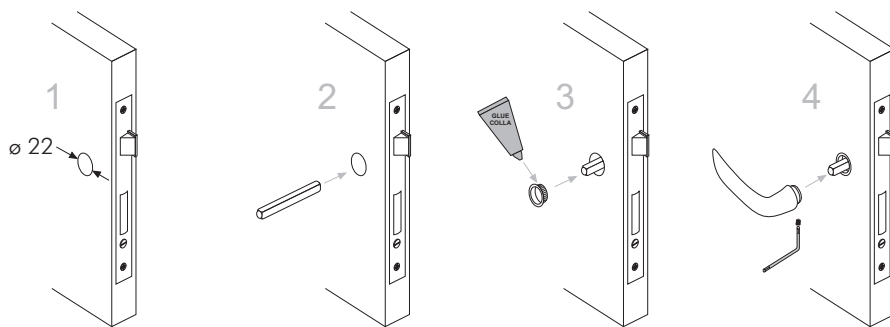

- 1) Eseguire un foro di 22mm di diametro nella porta.
- 2) Inserire il ferro quadro nella serratura, rivolgendo la fresata o il foro verso la posizione del foro grano presente sulla maniglia.
- 3) Apporre una piccola quantità di colla sul diametro esterno della rosetta (sulla parte che andrà inserita nella porta) ed inserirla nel foro sulla porta.
- 4) Posizionare la maniglia, e fissarla sul ferro quadro avvitando l'apposito grano finché questo non si blocca.

- 1) Drill a 22mm diameter hole into the door.
- 2) Insert the square spindle into the lock. The square spindle's milling or the hole has to be pointed to the handle's grub screw hole.
- 3) Put a small quantity of glue on the rose's outer diameter (on the part that will be inserted in the door). Insert the rose in the door.
- 4) Position the handle, then fasten the grub screw in the handle's designated hole, until it stops.

## ASSEMBLY SYSTEM H5

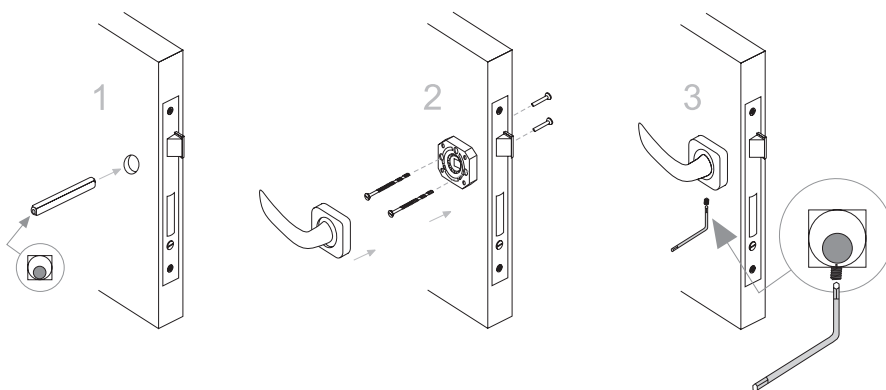

- 1) Inserire il ferro quadro nella serratura, rivolgendo la fresata o il foro verso la posizione del foro grano presente sulla maniglia.
- 2) Posizionare la sottorosetta in metallo e fissarla con le viti in dotazione.
- 3) Posizionare la maniglia montata sulla copertina sulla sottorosetta e avvitare il grano nell'apposito foro della maniglia finché non si blocca.

- 1) Insert the square spindle into the lock. The square spindle's milling or the hole has to be pointed to the handle's grub screw hole.
- 2) Position the metal under-rose aligned with the square spindle, then fasten with the screws.
- 3) Position the handle mounted on the rose cover on the metal under-rose and fasten the grub screw in the handle's designated hole, until it stops.



**F101**

Oro - Pavè

*Gold - Pavè*



**F102**

Argento - Pavè

*Silver - Pavè*



**F40**

Cromo antico nero

*Black aged chrome*



**F55**

Bronzo chiaro - Bronzo scuro

*Light bronze - Dark bronze*



**F58**

Oro francese antico rosso

*Red aged french gold*



**F59**

Argento antico francese rosso

*Red aged french silver*



**F99**

Argento vecchio

*Aged silver*



**F17A**

*Shabby chic*



**FN.O.**

Nero opaco

*Opaque black*



**FB.O.**

Bianco opaco

*Opaque white*



**F03**

Bronzo graffiato lucido

*Shiny satin bronze*



**F23**

Bronzo antico

*Aged bronzed brass*



**F43**

Bronzo graffiato opaco

*Opaque satin bronze*



**F.020**

Effetto ottone satinato opaco

*Opaque satin brass effect*



**F07**

Sabbia del deserto

*Desert sand*



**F13**

Effetto rame satinato opaco

*Opaque satin copper effect*



**F15**

Antracite

*Anthracite*



**F16**

Effetto cromo satinato

*Satin chrome effect*



**F45**

Ferro antico

*Antique iron*



**F54**

Effetto nickel satinato verniciato opaco

*Opaque satin nickel effect*



<b>F00</b>	Placcato oro 24K	<i>24K Gold plated</i>
<b>F01</b>	Ottone lucido	<i>Polished brass</i>
<b>F01E</b>	Ottone lucido - Ebano	<i>Polished brass - Ebony</i>
<b>F02</b>	Ottone satinato	<i>Satin brass</i>
<b>F04</b>	Cromo lucido	<i>Polished chrome</i>
<b>F05</b>	Cromo satinato	<i>Satin chrome</i>
<b>F06</b>	Nickel nero	<i>Black nickel</i>
<b>F08</b>	Ottone lucido - Cromo lucido	<i>Polished brass - Polished chrome</i>
<b>F09</b>	Bianco lucido - Ottone lucido	<i>Shiny white - Polished brass</i>
<b>F10</b>	Ottone lucido - Ottone satinato	<i>Polished brass - Satin brass</i>
<b>F11</b>	Cromo lucido - Nickel satinato	<i>Polished chrome - Satin nickel</i>
<b>F12</b>	Ottone lucido - Nickel satinato	<i>Polished brass - Satin nickel</i>
<b>F17</b>	Bianco lucido RAL 9016	<i>RAL 9016 shiny white</i>
<b>F18</b>	PVD giallo	<i>Yellow PVD</i>
<b>F19</b>	Ottone lucido non verniciato	<i>Unpainted polished brass</i>
<b>F20</b>	Nickel satinato	<i>Satin nickel</i>
<b>F21</b>	Nickel lucido	<i>Polished nickel</i>
<b>F21E</b>	Nickel lucido - Ebano	<i>Polished nickel - Ebony</i>
<b>F22</b>	Peltro opaco	<i>Opaque pewter</i>
<b>F24</b>	Cromo lucido - Nero soft touch	<i>Polished chrome - Soft touch black</i>
<b>F25</b>	Cromo satinato - Nero soft touch	<i>Satin chrome - Soft touch black</i>
<b>F26</b>	Alluminio verniciato opaco	<i>Opaque lacquered aluminium</i>
<b>F27</b>	Alluminio pavè	<i>Pavè aluminium</i>
<b>F29</b>	Nickel satinato PVD	<i>Satin nickel PVD</i>
<b>F31</b>	Cromo lucido - PVD	<i>Polished chrome - Yellow PVD</i>
<b>F32</b>	Cromo satinato - PVD	<i>Satin chrome - Yellow PVD</i>
<b>F33</b>	Cromo lucido - Nero opaco	<i>Polished chrome - Opaque black</i>
<b>F34</b>	Cromo satinato - Bianco opaco	<i>Satin chrome - Opaque white</i>
<b>F39</b>	Oro francese anticato nero	<i>Black aged french gold</i>
<b>F48</b>	Ottone antico	<i>Antique brass</i>
<b>F50</b>	Bronzo scuro	<i>Dark bronze</i>
<b>F53</b>	Bronzo uniforme	<i>Even bronze</i>
<b>F56</b>	Effetto nickel satinato lucido	<i>Shiny satin nickel effect</i>
<b>F57</b>	Nero soft touch	<i>Soft touch black</i>
<b>F60</b>	Inox satinato	<i>Satin steel</i>
<b>F61</b>	Inox lucido	<i>Polished steel</i>
<b>F62</b>	Inox satinato AISI 316	<i>AISI 316 satin steel</i>
<b>F63</b>	Inox satinato - Inox lucido	<i>Satin steel - Polished steel</i>
<b>F64</b>	Ottone lucido - Inox satinato	<i>Polished brass - Satin steel</i>
<b>F65</b>	Cromo lucido - Inox satinato	<i>Polished chrome - Satin steel</i>
<b>F66</b>	Cromo lucido - Cromo satinato	<i>Polished chrome - Satin chrome</i>
<b>F67</b>	Inox lucido AISI 316	<i>AISI 316 polished steel</i>
<b>F70</b>	Ottone vibrato	<i>Mill brass</i>
<b>F73</b>	Bronzo graffiato scuro opaco	<i>Opaque dark satin bronze</i>
<b>F77</b>	Nickel lucido - Nickel satinato	<i>Polished nickel - Satin nickel</i>
<b>F78</b>	Cromo vibrato	<i>Mill chrome</i>
<b>F79</b>	Nickel vibrato	<i>Mill nickel</i>
<b>F80</b>	Cromo lucido - Bianco lucido	<i>Polished chrome - Shiny white</i>
<b>F94</b>	Effetto cromo perla	<i>Pearl chrome effect</i>
<b>999</b>	Placcato argento 999	<i>999 silver plated</i>
<b>125</b>	Alluminio cromo perla	<i>Pearl chrome aluminium</i>
<b>126</b>	Cromo simil alluminio	<i>Chrome aluminium optica</i>



## QUALITÀ E MANUTENZIONE

Tutti i prodotti FIMET sono prodotti in conformità alle norme ambientali e con materiali di alta qualità, come da migliore tradizione italiana. La superficie dei prodotti può essere alterata da clima umido con alta percentuale di salinità, piogge acide, solventi, escursioni termiche e l'esposizione ai raggi ultravioletti. I nostri prodotti sono quindi sottoposti a test in nebbia salina in modo da ottenere un dato di riferimento per le nostre garanzie. Il test viene condotto in condizioni ottimali, dove le maniglie sono esposte solo alla nebbia salina. Pertanto, al fine di garantire il risultato ottenuto si consiglia di non utilizzare detergenti corrosivi e detergenti abrasivi o altri prodotti per la pulizia contenenti acido muriatico per la pulizia delle maniglie, ma solo un semplice panno morbido con acqua. Si consiglia inoltre di evitare di installare le maniglie quando l'ambiente è stato appena dipinto, perché l'esalazione della vernice può indebolire la superficie. Anelli, chiavi e oggetti appuntiti, in generale, possono danneggiare la superficie.

### **Le nostre finiture hanno raggiunto i seguenti risultati nel test in nebbia salina:**

<i>Ottone verniciato in cataforesi</i>	<i>oltre 250 ore</i>
<i>Bronzo verniciato in cataforesi</i>	<i>oltre 250 ore</i>
<i>Cromo galvanizzato</i>	<i>oltre 250 ore</i>
<i>Nickel verniciato</i>	<i>oltre 250 ore</i>
<i>RAL</i>	<i>oltre 250 ore</i>

Inoltre i nostri prodotti sono garantiti per 10 anni contro i difetti meccanici se installati correttamente. FIMET garantisce i propri prodotti esclusivamente quando vengono utilizzati in conformità con le cure necessarie. Danni superficiali causati da uso improprio o ad un'errata installazione non sono coperti da questa garanzia, né sono coperti il normale scolorimento dovuto all'usura o corrosione. Fimet non può in nessun caso essere ritenuta responsabile per danni derivanti da qualsiasi altra causa.

*Bianchi Vittore*

All Fimet products are produced in compliance with environmental rules and with high quality materials, as per best Italian tradition. The surface of the products can be altered by humid climate with high percentage of saltiness, sour rains, solvents, thermal excursions and exposure to ultraviolet rays. Our products are therefore submitted to salt spray test in order to obtain a reference data for our guarantees. The test is carried on optimal conditions, where the handles are exposed only to salt spray. Therefore, in order to guarantee the result obtained, we recommend not to use corrosive detergent and abrasive cleaners or other cleaning products containing muriatic acid when cleaning the handles, but only a plain smooth cloth with water. We recommend also to avoid installing the handles when the room has just been painted, as the exhalation of the varnish can weaken the surface. Rings, keys, and sharp object in general can damage the surface.

***Our finishing have reached the following results in the salt spray test :***

Cataphoresis varnished brass	beyond 250 hours
Cataphoresis varnished bronze	beyond 250 hours
Galvanized chrome	beyond 250 hours
Galvanized lacquered nickel	beyond 250 hours
RAL	beyond 250 hours

Moreover our products are guaranteed for 10 years against mechanical defects when installed correctly. Fimet guarantees its products solely when used in compliance with the necessary care. Surface damages caused by misuse or wrong installation are not covered by this warranty, nor are covered normal wear discoloration on finished or corrosion. Fimet can't in any case be held responsible for damages resulting from any other cause.

**Bianchi Vittore**

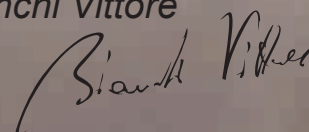



VERTICAL  
DISPLAY  
STAND



ROTATING  
DISPLAY  
STAND



ROTATING COUNTER DISPLAY





WALL DISPLAY



DISPLAY CASE



COLOR CHART







IN THE WORLD

MADE IN ITALY

- ALBANIA
- AUSTRIA
- BAHRAIN
- BELGIO
- BIELORUSSIA
- BOSNIA ERZEGOVINA
- BULGARIA
- CIPRO
- COLOMBIA
- CROAZIA
- DUBAI





## CONDIZIONI DI VENDITA

---

- Tutte le vendite vengono effettuate alle condizioni generali della ditta venditrice e potranno essere modificate solo con atto scritto della medesima.
- Tutte le vendite si intendono fatte "salvo approvazione della ditta".
- I prezzi si intendono franco ns. stabilimento. I prezzi sono sempre da intendersi al netto delle vigenti impostazioni fiscali.
- La merce viaggia a rischio e pericolo del committente anche se la spedizione avviene in porto franco
- Non verrà accettata merce in restituzione se non previo benestare della ditta venditrice.
- La ditta garantisce la ottima qualità dei prodotti e si impegna a sostituire solo il materiale che risultasse difettoso per carenza di costruzione.  
È però espressamente escluso il risarcimento di ogni eventuale danno.
- È nostra cura effettuare le consegne con la massima velocità consentitaci. Non vengono accettate richieste di risarcimento per ritardi di consegna.
- Qualsiasi reclamo sarà valido solamente se viene fatto per iscritto entro il termine di 8 gg. dal ricevimento della merce.  
Il reclamo s'intenderà decaduto qualora il compratore abbia consumato la merce.
- In caso di reclamo giustificato forniremo, per la merce resaci allo stato originale, della merce corrispondente all'ordine.
- Le illustrazioni e i dati tecnici riportati sui nostri cataloghi debbono essere considerati approssimativi potendo i modelli subire delle variazioni e modifiche senza obbligo di preavviso da parte della ditta.
- Per ogni controversia che si venisse a creare tra le parti sarà competente l'autorità giudiziaria di brescia.

## TERMS OF SALE

---

- All sales are made under the Seller's general terms conditions, and modifications may only be made upon written authorisation from the same.
- All sales are intended as "subject to the company's approval".
- Prices are quoted ex works and after deduction of the relevant taxes.
- All goods travel at the Buyer's risk even if despatched carriage free.
- Returned goods will only be accepted upon the Seller's approval.
- The manufacturer guarantees the quality of the products and undertakes to replace only goods found to have workmanship defects.  
Damages will not be refunded.
- We will do our utmost to make deliveries as promptly as possible. Claims for delayed deliveries will not be accepted.
- Claims will only be valid if made in writing within 8 days of receipt of the goods. Claims will not be valid if the buyer has used the goods.  
In the case of justified claims and goods returned in their original state, we will supply goods corresponding to the order.
- The drawings and technical data shown in our catalogues are to be considered as approximate since the models are subject to variation or modification at any time without prior notice.
- Any disputes between the parties will be put before the Court of Brescia.



FIMET MANIGLIE srl

Via Roma 24/A - 25070 Casto (Bs) - Italy  
Tel. +39 0365 870383 - Fax +39 0365 879530  
www.fimet-handles.com - mail@fimet-handles.com

---

MADE IN ITALY